



PHILIPS

RESPIRONICS

Amara View

Enjoy the
view

Full marks for no marks

The clever under-the-nose cushion design of Amara View gives you the widest field of vision of any leading full-face mask*. That's as well as redefining comfort by preventing red marks and irritation on the bridge of your nose*.



Smaller and lighter than any other comparable full-face mask, Amara View covers less of your face by doing away with the bulky cushion and frame in front of your eyes. It means you can comfortably wear glasses, read, watch TV or use a computer or a tablet before falling asleep.

Its unique cushioning promises no red marks for your nasal bridge, while still offering a great seal. The sympathetic and unobtrusive design gives it unparalleled appeal for patients and bed partners alike, making it easier to adopt and use – so you get better sleep and a healthier life.

Amara View features...

Just for you

- Innovative design prevents red marks, discomfort and irritation on the nose bridge*
- The smallest and lightest† of all comparable masks
- Widest field of vision of all leading full-face masks*
- Allows you to wear glasses, read and watching TV
- No bulky cushion and frame in front of your face and eyes

* Internal testing; data on file † Without quick release tube



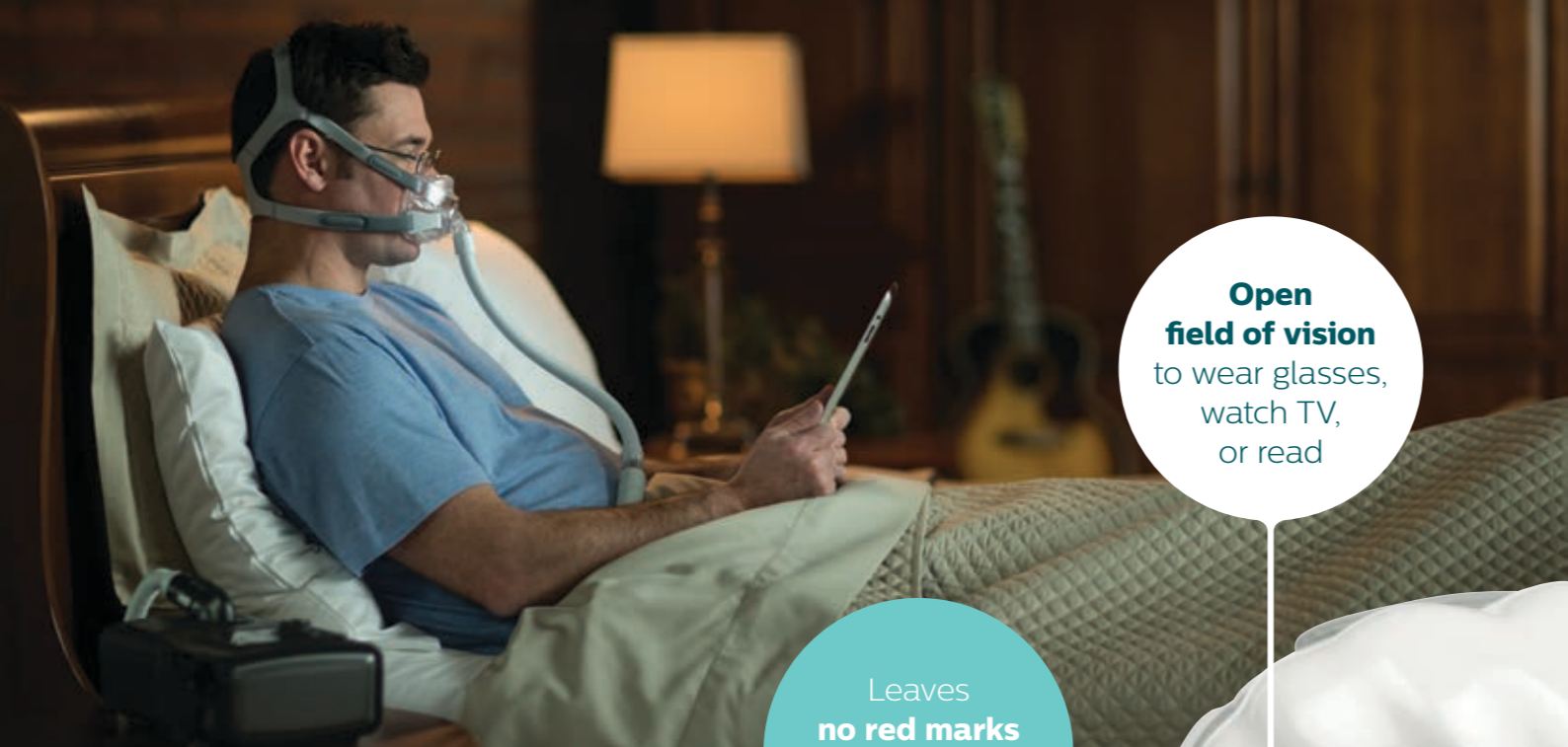

Open field of vision
to wear glasses,
watch TV,
or read

Leaves
no red marks
on the bridge
of your nose

It's easier than ever for your physician to find the right size mask for you and ensure it is fitted correctly, helping you benefit fully from market leading comfort and performance.

Fitting your Amara View is easy too, just remember that its sensitive design means it sits under your nose, not over like other full-face masks. Soft, adjustable straps help you achieve a comfortable fit.

20%
higher in ease
of use*

29%
higher
in comfort*

37%
higher in
overall appeal*

*Philips-Respironics sponsored testing at two contracted clinical sites. Ninety-five compliant patients rated one of the leading full face masks and then Amara View after approximately 30 days. Statistical significance at 95% confidence, +/- 5% using paired t-test comparing averages of 0 to 10 rating scores; p-value < .001



Helpful tips

Here are some handy tips to help you achieve a perfect fit and enjoy the comfort and performance of your Amara View.

- With your mouth slightly open, make sure the mask is resting comfortably against your face, with the cushion nostril opening under your nostrils, and the bottom of the cushion resting just above your chin. The headgear should be away from your eyes.
- The most common mistake is over-tightening the headgear. It should fit loosely and comfortably on your face. If your skin bulges around the mask or you see red marks, simply loosen the headgear.
- Assume different sleeping positions when fitting by moving around until comfortable. If there are any excessive air leaks, make final adjustments by adjusting the headgear top and bottom straps but also the headgear crown strap that prevents leaks to go to your eyes. some air leaking is normal.

Innovative under-the-nose design

Soft and comfortable fabric straps

Quick disconnect

Quick release tabs for easy on and off

Easy to use with one modular frame for all cushion sizes

Fitting guidance



1

Loosen the headgear to a large setting.
Grip and twist the headgear clips away from the frame to disconnect.



2

Choose the mask cushion size that adequately covers your mouth and seats comfortably around the base of your nose.
The bottom of the mask cushion should rest just above your chin with your mouth slightly open.



3

Gently holding the mask against your face, pull the headgear straps over your head and into position.
Ensure your nose is positioned over the cushion nostril opening.
Note: Do not place your nose inside the cushion nostril opening.



4

Press the headgear clips into place to connect.



5

Pull back the headgear tabs to evenly adjust the top and bottom straps.



6

Pull back the tab to adjust the crown strap and lift the headgear off of your ears. The headgear should sit loosely and comfortably.
Note: Be careful not to overtighten.



7

Assume different sleeping positions with the CPAP machine connected and turned on.
Move around until comfortable and make final adjustments should any excessive leaks be present.



Parts of Amara View

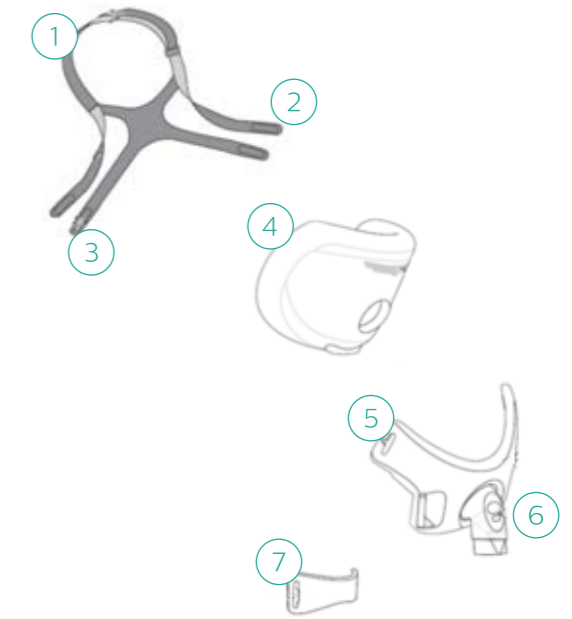

- ① Headgear crown strap
- ② Headgear top strap
- ③ Headgear bottom strap
- ④ Mask cushion with exhalation ports
- ⑤ Mask frame
- ⑥ Elbow with anti-asphyxia valve
- ⑦ Headgear clip
- ⑧ Quick release tabs
- ⑨ Quick release tube with swivel

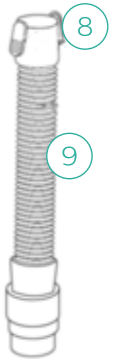

Ordering information

Item with exhalation port (Global version)	Part number
Amara View mask with headgear, FitPak	1090670
Small Amara View mask with headgear	1090602
Medium Amara View mask with headgear	1090603
Large Amara View mask with headgear	1090604
Item with exhalation port (Int. version)	
Small Amara View mask with headgear	1090662
Medium Amara View mask with headgear	1090663
Large Amara View mask with headgear	1090664

Learn more

www.philips.com/respironics

